



World Bank Financed Climate Smart Irrigated Agriculture Project (CSIAP)
Ministry of Mahaweli, Agriculture, Irrigation and Rural Development

SOCIAL SCREENING REPORT
MODERNIZATION AND DIGITALIZATION (CIVIL WORK) OF
VANTHARAMOOLAI AGRARIAN SERVICE CENTER -
BATICALLOA DISTRICT



Submission

Deputy Project Director Office of the CSIAP - Eastern Province

30 - January - 2020

Contents

1. Project Description.....	3
2. Social Screening Checklist.....	Error! Bookmark not defined.
3. Estimate of Specific Impacts and Information on Affected Persons.....	21
4. Decision on Categorization, After reviewing the answers above, it is determined that the sub project will have:	22
5. Impact Categorization	22
6. Submission of the Social Screening Report	23
7. Social Management Plan for ASC Modernization and Digitalization (Civil Work).....	0
8. Activity Plan for ASC Modernization and Digitalization (Civil Work).....	0
Annex: 01 Location map (Division map - Pulmoddai ASC)	0
Annex: 02 Attendance Sheets of the participants during the meetings and discussions.....	2
Annex: 03 Public/ Community Consultation and Disclosure.....	Error! Bookmark not defined.
Annex: 04 Pictures during the meetings, discussions and field visits.....	5
Annex: 05 Drawing of the subproject	7
Further Annexes 06.....	8

Abbreviation

ARAP	Abbreviated Resettlement Action Policy
ARPA	Agriculture Research and Production
ASC	Agrarian Service Centre
CBO	Community Based Organization
CKD	Chronic Kidney Disease
CSIAP	Climate Smart Irrigated Agriculture Project
DAD	Department of Agrarian Development
DSD	Divisional Secretariat Divisions
FGD	Focus Group Discussion
FO	Farmer Organization
GAP	Good Agricultural Practices
GBV	Gender Based Violence
GND	GramaNiladhari Division
GOSL	Government of Sri Lanka
GRC	Grievance Redressal Committee
HAS	Hot Spot Areas
ICT	Information and Communication Technology
IEC	Information and Education Campaign
KII	Key Informant Interview
LKR	Lanka Rupee
MOH	Medical Officer of Health
PG	Producer Group
PMU	Project Management Unit
SA	Social Audit
SIA	Social Impact Assessment
SITHAMU	Sinhala Tamil and Muslim
SMP	Social Management Plan
SP	Southern Province
SSR	Social Screening Report
WB	World Bank
WFO	Women Farmer Organization
WHF	Woman Headed Family
WRDS	Women Rural development Society

1. Project Description

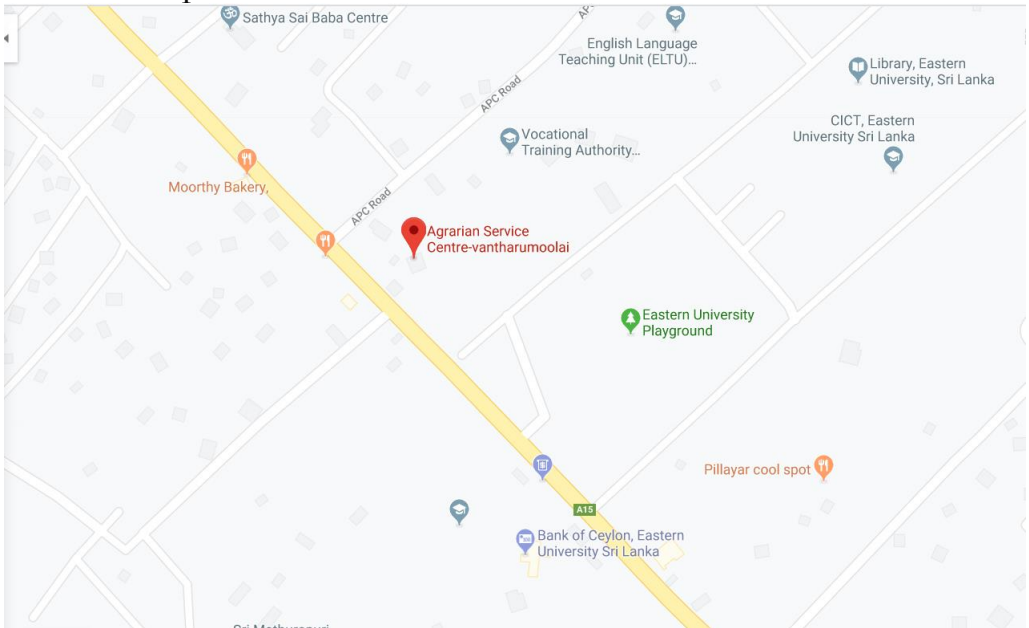
Name of Sub project:	Vantharumoolai Agrarian Service Centre Modernization and Digitalization (Civil Work) in Eravurpattu DS Division in Batticaloa District.
Geographical coverage and location of the Subproject	<p>Province- Eastern Province District - Batticaloa DS Division- Eravurpattu DSD ASC- Vantharumoolai Agrarian Service Centre Located GN - Vantharumoolai East GN Division Location Map:</p>  <p>Source: Google Map</p>
Nature of the sub project:	It is mainly a Repairs of Vantharumoolai A.S.C at Eravurpattu Divisional Secretariat Division in Batticaloa District.
Size/ scale/ Cost of the Sub Project	Rs.8,739,720.11
Project implementing agency:	<p>Department of Agrarian Development, Batticaloa which is the implementing agency. DAD with its network of officials based in the ASCs directly involved in implementing the subproject. Similarly, the staffs of the CSIAP based in national to divisional level will also involve in different stages of the implementation process appropriately. It is expected that all the service providing agencies such as Department of Agriculture, Department of Irrigation, Forest Department, Department of wildlife & Coconut development board etc. will also support to implement the subproject effectively. From the community side, FOs, agriculture committee associated with the ASCs, WFOs will also contribute to implement the project. Similarly, the farmers in general</p>

	will support to implement the project by tolerating the difficulties that would be created during the construction period.
Specific objective and beneficiaries of the sub project:	<p>For the ASC to function in the CSIAP Project area as a sophisticated, modernized well-furnished and a resourceful one stop service center catering to present and future needs of farming community in order to increase their livelihood, income and agriculture productivity.</p> <p>From this project 20,412males and 21,329females will get the benefits directly or indirectly. Source - Eravurpattu Divisional Profile, 2019</p>
Sub Project Descriptions:	<p>Proposed sub project of repairs of Vantharumoolai ASC include following activities,</p> <p><u>New intervention works: -</u></p> <ol style="list-style-type: none"> 1. Construction of boundary wall and Gate Excavation, Masonry work, Brick work, plastering work, Decorator & painter, Supplying and fixing main gate 2. Construction of Fertilizer Store - 1 Brick work, reinforcement, plastering, pavior, roof work, painting work, structural steel work, electrical installation 3. Construction of Fertilizer Store -2 4. Construction of Bike Parking <p>No any Repairing works proposed in the ASC.</p> <p>The sub project will be implemented during the period from January 2020 to October 2020.</p>
Land Acquisition	The proposed subprojectdoes not involve land acquisition.
Subproject Justification	<ul style="list-style-type: none"> ✓ Reasons for the repair of the existing ASC (civil work) is majority of the respondent and the persons interviewed responded that the space available within the existing building was not adequate at all to provide a better service for the increased demand of the farmers. ✓ Officer space for running various units of the service providers of the government sector is not adequate. ✓ Officers space for running various units of the service providers of the government sector is not adequate. ✓ Storage facilities for seed paddy, fertilizers etc. also limited. Higher

number of farmers visiting to this ASC for get fertilizer but in existing fertilizer store has not enough space for store high number of fertilizers, if we go for construction of fertilizer store that will lead to increase of agriculture production in Vantharumoolai ASC division. Already two fertilizer stores are there but there are inadequate space for store fertilizer, therefore during our subproject component decided to extent space of those stores.

- ✓ In many of the centres, there is no proper and spacious place with necessary equipment to conduct awareness programmes for the farmers.
- ✓ The ASC has suitable space for construction of bike parking that will ensure easy access for farmers.
- ✓ The ASC has 2 side boundary walls (front side of ASC & right side of ASC) but left side barbed wire fence identified. Construction of boundary wall will help to protect the ASC.

General Profile of the Community Under the Vantharumoolai ASC, there are 19 GND. The total numbers of families are 12,102 and total number of farm families 10,508. women headed families are 588. The details are below:

Table No: 01 General Profile of the Community

Name of the GND	Number of GND	No of Villages	Total Number of Families	Total Number of Farm Families	Total Number of women headed farm Families
Chenkalady-1	195/1	4	1124	980	16
Chenkalady-2	195	5	561	520	14
Kommathurai west	196A	3	303	265	13
Kommathurai North	196B	3	486	425	57
Kommathurai East	196	1	536	512	45
Vantharumoolai East	197	2	995	852	39
Vantharumoolai West	197B	1	1132	960	32
Mylaveduvan	197D	3	73	56	0

Palacholai	197C	4	504	432	8
Mavadivempu-1	197A	3	995	853	162
Mavadivempu-2	197E	1	726	682	21
Sittandy-1	201/1	2	884	812	6
Sittandy-2	201/2	1	283	264	64
Sittandy-3	201/3	8	659	248	19
Sittandy-4	201/4	3	663	660	17
Kaluvankerny-1	198	8	762	692	15
Kaluvankerny-2	198A	6	636	620	17
Eralakulam	201A	39	350	265	14
Koduvamadu	195A	3	430	410	25
Total		100	12,102	10,508	588

Source -1. Divisional statistical Hand book, Eravurpattu, 2019
2. ASC, Vantharumoolai, 2019

Table No: 02 Demographic Details

Ethnicity (Number of Families)		Religion (Number of families)	
Sinhalese	1	Buddhist	0
Tamils	12,071	Hindus	11,277
Sri Lankan Moor	1	Islam's	0
Burghers	1	R.C	391
Others	0	Other Christians	408
Total	12,074	Total	12,076

Source - Source - Divisional statistical Hand book, Eravurpattu - 2019

Primary livelihood of the community

Table No: 03 Primary livelihood of the community

	Occupation	Total numbers of Persons
01	Paddy Farmers	6,856
02	High land farmers	3450
03	Fishing	280
04	Others (Business, Daily wages)	10,586

Source - ASC, Vantharumoolai, 2018
Agriculture extension center, Vantharumoolai, 2019

Most of peoples doing several livelihood activities like farming, fishing, Business and daily wages.

Nature of the land ownership for the

Land of the existing ASC owned by the DAD. ASC has adequate and underutilized lands for the proposed construction. Therefore, the

subproject	proposed civil work will not have any risks from having to obtain additional land. Therefore, the subproject activities can be implemented without causing any displacement or impact to people living adjacent to the ASC. Issues in resettlement will not arise.
Land ownership pattern of people in the area (Ex: squatters, titleholders, tenants)?	<ul style="list-style-type: none"> ▪ Major land extent - 4,262 Ac ▪ Minor land extent - 3,368 Ac ▪ Rainfed land extent -10,958Ac
Gender Issues	<p>Following is a description of the gender issues are concerning the communities in the impact area of the Vantharumoolai ASC:</p> <ul style="list-style-type: none"> ▪ In the farming activities, both men and women are actively involved in this ASC and women farmers actively involved in farming activities such as land preparation, seeding, planting, weeding, harvesting, preparation for marketing and they more contribute to livestock management. ▪ In every farming activity, allocated payment of wages for female labour is much less than the male labour. However, female headed family labours are hired for farming activities without proper allocated wages and faced more difficulties. ▪ In the ASC division Farmer Organizations (FO) and Women Farmer Organizations (WFO) are actively participated in each GN Divisions. WFO also actively participated in paddy farming activities and they do not have much opportunity to benefit from extension services. ▪ In Farmer Organizations women farmers are selected to executive committee members, however males are dominated to decision making process and give less opportunity for female farmers. (Details annexed in Table 07) ▪ In the ASC division 29 SiThaMu Women farmer organizations actively participates in each GN Divisions and they have limited opportunities for agriculture related trainings, trainings on machinery and technology due to increasing the responsibilities and work load in their homes. ▪ Most of the female headed households are living in rural areas and restricted for gathering the knowledge in technical business skills and access to markets.

	<ul style="list-style-type: none"> ▪ Female participants also support to the agricultural activities and widows are not willing to participate the Farmer organizations and agriculture related trainings or workshops. ▪ In this ASC division have Women headed farm families and they have additional problems in farming process and they do not have land ownership which restrict to access the water facilities and fertilizer subsidies. ▪ In the Vantharumoolai ASC division, there are two toilets and not to be separated for Male and female staffs and farmers.
Social Capital – community-based organizations	<p>The following community-based organization identified in Vantharumoolai ASC Division.</p> <ul style="list-style-type: none"> - Farmer Organization (FO): F:O-24 - Woman Farmer Organization (WFO):W: F:O – 29 <p>Source – Divisional statistical Hand book, Eravurpattu, 2018</p>
On-going Development Projects	<p>There are no development projects being implemented in the project area.</p>
Frequenting Visitors	<p>Outside peoples coming for collecting paddy seeds and ground nut. Farmers (Men and Women) visit to ASC for getting fertilizer and subsidies.</p>
Social Impacts Positive Impacts	<ul style="list-style-type: none"> • This subproject will benefit the local population of the area, especially for farming communities. • ASC will also serve as a place for ASC staff and community to interact, to share knowledge and create awareness about project. Therefore, the ASC will enhance community participation and relationships between ASC staff and farmers. • The sub project will provide high-quality advisory services for farmers and agribusinesses in Vantharumoolai and support the establishment of the farm machinery unit. The farm machinery unit will support farm machinery training, extension, business development and marketing facilities. Thus, will lead to increased technical knowledge of farmers in paddy cultivation. • Once the project is complete, benefits will start to flow almost immediately with the onset of rain and the long term through enhanced resilience.

	<ul style="list-style-type: none"> • The two communities interacting with each other, government officers and contractors in the process of jointly conducting social auditing, participating in irrigation water management, training and extension, business development and marketing will reap benefits in the form of valuing working together despite differences along with increased knowledge and awareness. • Overall, the completed project will bring about poverty deduction, inclusive development and shared prosperity. • CSIAP staffs and community people share their knowledge and make awareness of this project through this community participation also enhanced. Staff of ASC division and farmer's relationship will enhance.
Negative Impacts	<ul style="list-style-type: none"> • During office hours noise and dust come from the construction work that will disturb to officers and farmers. Materials storage and machinery parking somewhere near the site will also cause some disturbances to the community. • A labour camp may be established and there could be impacts from labour influx-however, will be very minimum considering that only limited number of labourers (approximately 5) may come from outside. • There are some sensitive areas located near to the construction site. Eastern University of Sri Lanka located within 100m distance& Veterinary service centre located close by ASC. • When constructions are carried around schools, preschools maximum precautions are required to ensure the safety of children. Due to curiosity children may try to enter into the worksites and look through the manholes or meddle with the equipment etc. •
Mitigation Measures	<ul style="list-style-type: none"> • The social issues in any infrastructure developments project are common and cannot be avoided. Also, it is important to note that the majority of social issues are emerged and aggravated due to absence of realistic methods of constructions and systematic approach. • For example, contractor will be required to do water sprinkling to minimize impacts from dust and carry out noise generating work during day time while ensuring noise pollution is kept to the

minimum. Public access to the site to be prohibited or controlled via adequate fencing and signage in order to avoid risk to the public.

- There should be special arrangements at worksites closer to schools at the time of starting and closing of preschool and schools.
- All contractors will be required to develop and implement written labour management procedures, including procedures to establish and maintain a safe working environment.
- Adequate care and measures will be taken to avoid any violation of use of labour accidents, or disputes with local communities due to use of non-local labour force used for constructions, risks associated with influx of non-local workers.
- The contractors would be encouraged to use as much as possible locally hired labour.
- Since the civil construction works will be carried out using proper construction practices and there will be no adverse impacts on the properties, residential and other structures of the community located at a distance from the site. However, there will be some temporary impacts due to the project implementation in respect of which mitigation measures are proposed.
- The contractor will also be required to employ an environmental and social officer to address any issues that may crop up during project implementation. All contractors will be required to develop and implement a code of conduct for labourers, including procedures to establish and maintain a safe working environment.
- The staff and workers will be given an orientation on appropriate behaviours to ensure no disturbance to the community life and officers of the ASC. Adequate care and measures will be taken to avoid any violation of use of labour, accidents, or disputes with local communities and other risks associated with influx of non-local workers.
- Through the relevant officials the FOs will request the contractor for employing local labour to the maximum extent possible and hire village vehicles for material transport. Any individual requests for service by the contractor will be conveyed to the authorities and will be attended to without compromising the project activities and social and environmental concerns.
- The mitigation measures including the appointment of an

	<p>environmental and social officer, will be included in the specifications for the main contract, and monitored by the project management to ensure compliance.</p> <ul style="list-style-type: none">• Grievance redress mechanism and Social Audit Committees will be established to allow ASC staff to raise any complaints and provide feedback regards construction activities.
--	---

2. Social Screening Checklist				
Screening/ assessment questions Project type	Yes	No	Low/ mediu m/maj or impact s	Description/ Details
Background				
1. Will the subproject/ intervention include new physical construction work? (Attach a copy of technical design) and what is extent of the works - small, medium, large?	√		Low	Construction of Fertilizer store - 1, Construction of Fertilizer store - 2, Construction of Boundary wall and gate, Construction of Bike parking. These are medium scale construction.
2. Does the subproject/ intervention include upgrading or rehabilitation of existing physical facilities? (Attach a copy of technical design) and what is extent of the works - small, medium, large ?	√			Repair of Agrarian Service Center These are small sale rehabilitation.
Project site and land acquisition and Livelihood Related Impacts				
3. Is the site chosen for this work free from encumbrances (Ex: squatters, crops, trees, houses, other structures walls etc)		√	Low	Neem tree - 4 Eucalyptus - 1 Arecanut tree - 2 Acacia tree - 1 Manchavana tree - 1 Palmira tree - 1 Kalothiyai - 1
4. Is the site chosen for this work in possession of the implementing agency?	√			Department of Agrarian Development, Batticaloa which is the implementing agency.
5. If the land is owned by other government agencies, has action been taken to transfer these lands to CSIAP managing entity? (Attach evidence of transfer)		√		The identified land belongs to Agrarian Department- Batticaloa.
6. Does the sub project intervention require				

acquisition of private land?		√		
7. If the land parcel has to be acquired, is the actual plot size and ownership status known? (Mention the details)				Not Applicable
8. If the site is privately owned, can this land be purchased through negotiated settlement?				Not Applicable
9. If any land required for the work is privately owned, are these land owners willing to voluntarily donate the required land for the CSIAP rehabilitation / development? (if yes attach the concern letter)				Not Applicable
10. Will the affected land/ structure owners likely to lose less than 10% of their land of structures area?				Not Applicable
11. If so, are these land or structure owners willing to voluntarily donate the required land for this sub project?				Not Applicable
12. If the land owners are willing to donate the land, do they lose more than 10% of their land / structure in this location due to of donation?				Not Applicable
13. Are there any previous land acquisition where the identified land has already been acquired?		√		
14. Is the land for material mobilization vehicular movement, transport for the civil work available within the identified worksite or right way?	√			Land for the material mobilization vehicular movement and transport for the civil work are available. Near the construction site, there are government departments and university (EUSL) observed. Therefore, lack of parking space will not be serious issue in the subproject area.

Project impacts				
15. Is the project/ intervention likely to cause any permanent damage to or loss of housing, other assets, resources use?		√		
16.If yes, are these damages likely to be full or partial (Ex: entire structure having to be demolished versus part of the structures being damaged?)				Not Applicable
17. Will there be loss of / damage to agricultural lands, standing crops, trees due to acquisition of lands, construction of facilities etc?	√		Low	Neem tree - 4 Eucalyptus - 1 Arecanut tree - 2 Acacia tree - 1 Manchavana tree - 1 Palmira tree - 1 Kalothiyai tree - 1 observed in identified place.
18. Will there be any permanent or temporary loss of income and livelihoods because of the civil works? If so for what period? Also, please specify whether it is likely to be temporary or permanent.		√		
19. Have these people/ businesses who may suffer temporary or permanent loss of incomes or livelihoods been surveyed and identified for payment of any financial assistance?				Not Applicable
20. Will there be any adverse impacts (inconvenience/ restriction of access, damage to properties) on the people/ communities due to construction related transport/ other activities etc?		√		But during working hours there will be some disturbances to staff i.e. from noise and dust.
21. Will there be any impacts on cultural, community properties or facilities?		√		
22. Will the project cause any other temporary or permanent impacts? Pls describe		√		
Livelihoods related impacts				
23. is there any loss of crops, assets, business etc.		√		

24. Are there any non-titled people (squatters) who are living/ or doing business who may be partially or fully affected because of the civil works?		√		
25. Have measures been planned to mitigate temporary impacts including ease of access? Give details?	√			Temporary impacts will be addressed/mitigated according to the SIMP.
Resettlement impacts				
26. Does this project involve resettlement of any person? if yes, give details		√		
27. Is there any physical displacement of persons due to project construction?		√		
28. Does this project cause any temporary relocation of people during construction?		√		
29. Is there any economic displacement (possibility to move out, close of business/ commercial/ livelihood activities of persons) during construction?		√		
30. Will people permanently or temporarily lose access to facilities, services, or natural resources? e.g firewood collection and other rural livelihood sources linked to forests and government land		√		
31. Are there any vulnerable people/ groups (poorest/ women headed households/ elderly families, single parents, families with disable persons) living in the proposed locations or affected / benefitted by the project intervention? (give the number)	√			Vulnerable people/groups will not be negatively affected due to the civil works. They will be benefited directly or indirectly. The details are below: Samurdhibeneficiaries- 5,691 families. Woman headed - 588 families.

				Widow headed - 1,588 families. Disable headed - 133 families. Child headed - 8 families. Elder headed- 980 families. Source - Divisional Secretariat, Eravurpattu, Village Development Plan - 2019.
32. Are there any indigenous people living in the proposed locations or affected/ benefitted by the project intervention? (give the number)		√		
Impacts from labor influx				
33. Will the project potentially involve an influx of workers to the project location?	√			
34. Will the influx be considered significant for the local community?	√			
35. How many workers will be needed for the sub project, with what skill set, and for what period?	√			Approximately 12 skilled workers and 25 unskilled workers are needed for 3-4 months.
36. Can the project hire workers from the local workforce? And what is the size and skill level of the existing local workforce?	√			Skilledlabors- 760 M-615, F-145 Unskilled labors - 1,128 M - 757, F-371 Source - Divisional Resource profile, Eravurpattu - 2018.
37. If the skill level of the local workforce does not match the needs of the project, can they be trained within a reasonable timeframe to meet project requirements?	√			Workforce is available at the local community and contractor will bring his workforce if

				needed.
38. Will there be workers brought in from outside?	√			
39. How will the workers be accommodated? Will they commute or reside on site? If so, what size of camp will be required?		√		They will find a house for rent.
40. Based on the socio-economic, cultural, religious and demographic qualities of the local community and the incoming workers, is there a possibility that their presence or interaction with the local community could create adverse impacts?		√		Hence, majority of the incoming workers would be from similar socio-economic, cultural, religious or demographic background.
41. Will the incoming workers use or create competition for these resources?		√		
42. What is the expected duration of the incoming workers' presence in the community? Or frequency and extent of contact between the local community and outsiders?				Approximately 3-4 months.
43. Will the incoming workers be from a similar socio economic, cultural, religious or demographic background?	√			Most Probably similar.
44. Given the characteristics of the local community, are there any adverse impacts that may be anticipated?		√		The local community is Tamil speaking and majority of them are Tamils. So same language speaker will be preferable for minimized unwanted social issues.
45. Is the project located in a rural or remote area?	√			The identified project site is located in a rural area.
46. Is the project located / being carried out in an area that is not usually frequented by outsiders?	√			Men and women visit to the ASC for getting fertilizer and

				subsidies.
47. Are there sensitive social conditions that need to be considered?		√		
Community participation				
48. Has the project received community consent and support?	√			1 IEC Meeting conducted. 1 CBO meeting conducted.
49. Are there any CBOs or other that exist in the selected locations?	√			Farmer org -24 Woman Farmer Org (SiThaMu) -32, Source -ASC, Vantharumoolai-2019.
50. Will the project mobilize these CBOs for GRM/ Social Audit/ etc activities?	√			Grievance Redressal Committee will be established to address/resolve issues.
51. If CBOs are involved, do these organizations have prior experiences in GRM/ Social Audit/ etc practices?		√		The project has to be trained the people.
52. Do the CBOs identified for the CSIAP activities transparent and accountable and free from any form of corruption/ abuse?	√			
53. Will the project expect any counterpart contribution from the beneficiary households? (if yes, what is the expected contribution)	√			Community can support with shramadana activities 3 persons from each FO can contribute two hours per day shramadana activities. (e.g. unskilled voluntary work).
Gender Based Violence				

54. Is the subproject in an area of the district with a humanitarian or emergency situation?		√		Rehabilitation works of ASC Vantharumoolai.
55. Undertaken consultations with women's groups?	√			In the ASC Division arranged one community consultant meeting, both men and women farmers were participated and no arranged separate meeting with women farmers. Two discussions conducted with ASC staffs.
56. Issues related to GBV and GBV-related concerns about the project have arisen in the community engagement discussions?		√		Gender based issues or violence not identified and not recorded during the community consultant meeting and discussions.
57. Are military or paid security forces being contracted as part of the project? (Having military or paid security forces contracted as part of a project can increase the risk of GBV.)		√		Contract with registered Contractors.
58. Is the project district in lowest poverty quartile of country? (Regions in the lowest poverty quartile of a country may be underserved and the most vulnerable to neglect)	√			National Poverty line value of Sri Lanka Rs.4,939.00 expenditure for person per month in Batticaloa District Rs. 5,030.00. (Department of census & Statistics - Sri Lanka December,2019)

				<p>In VantharumoolaiASC under the Eravurpattu DS Division.</p> <p>Income level (per month per family)</p> <ul style="list-style-type: none"> - 5,447 families income come under below Rs. 10,000.00. - 6,676 families income come under above Rs.10, 000.00 <p>(Income details annexed)</p> <ul style="list-style-type: none"> - 5,691 families are Samurdhi beneficiaries (Source - Divisional Secretariat, Eravurpattu, Village Development Plan - 2019).
59. Is the subproject in hard-to-supervise areas? (Lower risk is easily accessed project areas. Higher risk is hard-to-supervise areas)		√		
60. Is the subproject construction near school route or other pedestrian access that women and girls use for their daily activities?		√		<p>Vantharumoolai ASC come to under the Eravurpattu Chenkalady pradesiya Sabah and situated in A15 road and nearby Eastern University. (Within 200m distance)</p> <p>Schools - 04 University - 01 Religious Places</p> <ul style="list-style-type: none"> - Hindu temples- 04

				<ul style="list-style-type: none"> - Church - 01 Government offices - Predeshiya Saba - 01 - Vocational Training centre Markets - 01 Shops - around 50 Hospital - 00 Bank - 02(People's Bank, Bank of Ceylon) <p>(Source: ASC Vantharumoolai).</p>
61. Will the subproject be able to monitor implementation across the full span (both in terms of geographic spread and duration) of the work?	√			
62. Will female workers be in close proximity to male workers with limited supervision?	√			In the ASC modernization project female workers are like to involve in the "Shramadana" work and no any issues in working together with male workers in the limited supervision.

3. Estimate of Specific Impacts and Information on Affected Persons

Estimates of specific impacts	Number/ Amount/ Ha
- Private land required (Sq. m)	0
- Total number of households affected	0
- Number of individuals losing more than 10% of land area	0
- Government land required	Yes (and Available)
- Number of shops affected	0
- Number of utilities affected	0
- Number of workers to be brought from outside	12 skilled laborers are needed. (Approximate number)

4. Decision on Categorization

Decision on Categorization, after reviewing the answers above, it is determined that the sub project will have:	
High/ substantial impacts	
Moderate impacts	
Low/ no impacts	√

5. Impact Categorization

Conclusion and Screening Decision (to be filled by the PMU)
<p>Social impacts of the proposed sub project</p> <ul style="list-style-type: none"> • <u>No Impacts: there is no land acquisition because these are permit lands and no loss of livelihoods if the works are completed during the dry/off season, Social Screening Report (SSR), Social Impact Management Plan (SIMP) [required if civil works involved] ...√.....</u> • Minor Impacts: Less than 200 individuals affected; no physical displacement; & affected persons lose less than 10% of their productive assets, SSR, Abbreviated Resettlement Action Policy (ARAP), SIMP.....Temporary impacts only. SSR with SMP submitted..... • Significant Impacts: More than 200 individuals affected; cause physical displacement; affected persons lose more than 10% of productive assets, SSR, SIA, census survey, RAP with R&R assistance & income restoration measures.....

6. Submission of the Social Screening Report

Submission By:

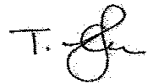

T.Sekaran
Social Safeguard Officer
DPD Office - Eastern Province
Date:30.01.2020
Email: thsekaran@gmail.com
Contact No: 077-5228125

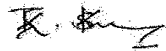

S.Kayalvili
Gender Development Officer
DPD Office - Eastern Province
Date:30.01.2020
Email: tdkkayal@gmail.com
Contact No: 077-4149390

Report Reviewed and Recommended By:



Ms. Sharmila Shanmuganathan
Social Safeguard and Gender Development Officer
Project Management Unit (PMU)
Climate Smart Irrigated Agriculture Project (CSIAP)
Date: 30 - 01 - 2020
Email: sociologistsharmila@gmail.com
Contact No: 077-2437310

Ms. Sharmila Shanmuganathan
Social Safeguard & Gender Development Officer
Project Management Unit
Climate Smart Irrigated Agriculture Project
Ministry of Agriculture

Approved By:

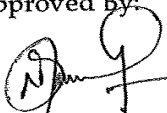

Eng. N. Sivalingam
Project Director

Climate Smart Irrigated Agriculture Project (CSIAP)

Eng. N. Sivalingam
Project Director
Climate Smart Irrigated Agriculture Project
Ministry of Agriculture.

7. Social Management Plan for ASC Modernization and Digitalization (Civil Work)

Social Impact Mitigation Plan for the ASC modernization and Digitalization (Civil Work) Subproject				
Issues/ Impacts and risks	Mitigation Measures	Institutional Responsibility		Mitigation Cost
		Implementation	Supervision / Monitoring	
General (for all types of risks, issues and disturbances)	<ul style="list-style-type: none"> A GRM will be established to receive and resolve complaints/grievances related to disturbances caused by construction including GBV related issues. Awareness will be created on the GRM among community and ACS staff and will publicly display the contact details to report grievances. Awareness will be created among community on risks/issues including GBV issues due to labour influx arising from construction activities and safety/mitigation measures that will be in place. 	Social/Environment safeguard officer - ACS/CSIAP	PMU	Included in sub project's safeguards budget.
Disturbances due to heavy machinery movement & temporary use of land for material storage and parking.	<ul style="list-style-type: none"> An officer will be appointed to implement & monitor social/environment safeguards mitigations measures during construction. Community and ACS staff will be informed of construction activities/schedule, and mitigation measures that will be in place. <p>Consultation with ACS staff and community will be conducted to identify land for material storage,</p>	Contractor	Social/Environment safeguard officer - ACS/CSIAP	Included in construction cost.

	<p>camp setup, equipment parking and routes to transport material that cause minimum disturbances to community & ACS activities.</p> <p>If there are damages caused to local roads and other utilities during construction, contractor shall attend to the repairs/rectification of the damages.</p>			
Construction related disturbances from noise & dust etc.	<ul style="list-style-type: none"> Dust barriers will be installed surrounding the construction. Water sprinkling will be done to minimize impacts from dust. Dust masks to be provided to all laborers for the use at required times. The construction will be carried out in a manner to minimize noise pollution. The construction works with heavy sound should will be timed to avoid office working time period. 	Contractor	Social/Environment safeguard officer - ACS/CSIAP	Included in construction cost.
Labour Influx related issues (e.g. GBV)	<ul style="list-style-type: none"> Local labour will be hired where possible - Contractor will give priority towomen when hiring. Worker Code of Conduct will be included as part of the employment contract - this should define workers' commitment in attitudes and behaviour to preventing, combating and responding GBV. Contractors will implement robust measures to prevent sexual harassment/GBV including training of workforce and sanctions for non- 	Contractor	Social/Environment safeguard officer - ACS/CSIAP	Included in construction cost.

	compliance (e.g. termination).			
Public/ occupational safety Hazards, and on impacts on environment.	<ul style="list-style-type: none"> • Public access to the site will be prohibited or controlled via adequate fencing and signage in order to avoid risk to the public. • Contractors shall take precautions to minimize mosquito breeding, where the pit fills with water. • Environment Management Plan will provide more details regards measures to prevent/mitigate impacts to the environment including pollution, deforestation, soil erosion and management of solid waste. 	Contractor	Social/Environment safeguard officer - ACS/CSIAP	Included in construction cost.

Annex: 01 Location map (Center map - Vantharumoolai ASC)

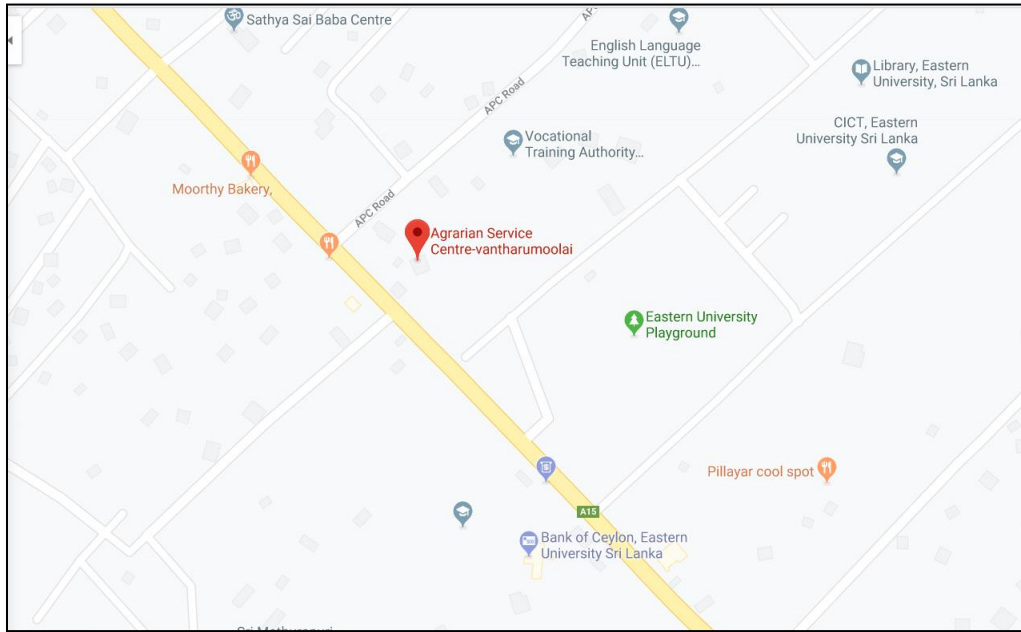

Source: Google Map

Outside View of ASC Vantharumoolai



Front View of ASC Vantharumoolai



Fertilizer Store of Vantharumoolai ASC



Plan of Existing ASC building - Vantharumoolai

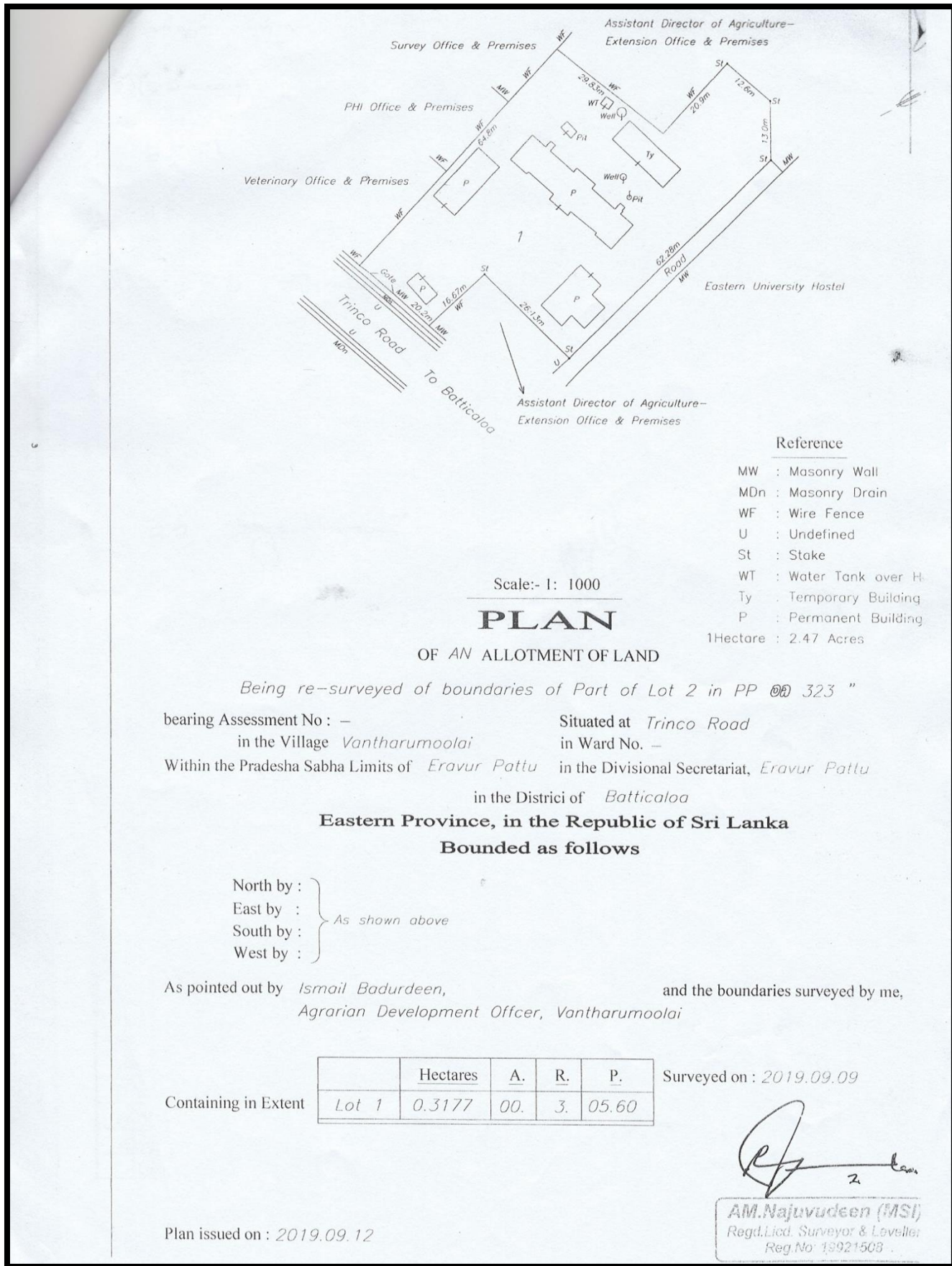

Reference

- MW : Masonry Wall
- MDn : Masonry Drain
- WF : Wire Fence
- U : Undefined
- St : Stake
- WT : Water Tank over H.
- Ty : Temporary Building
- P : Permanent Building
- 1Hectare : 2.47 Acres

Scale:- 1: 1000

PLAN

OF AN ALLOTMENT OF LAND

Being re-surveyed of boundaries of Part of Lot 2 in PP 00 323 "

bearing Assessment No : - Situated at Trinco Road
 in the Village Vantharumoolai in Ward No. -
 Within the Pradesha Sabha Limits of Eravur Pattu in the Divisional Secretariat, Eravur Pattu
 in the District of Batticaloa
Eastern Province, in the Republic of Sri Lanka
Bounded as follows

North by : }
 East by : } As shown above
 South by : }
 West by : }

As pointed out by Ismail Badurdeen, and the boundaries surveyed by me,
 Agrarian Development Officer, Vantharumoolai

	Hectares	A.	R.	P.
Containing in Extent	Lot 1	0.3177	00.	3. 05.60



Surveyed on : 2019.09.09

Plan issued on : 2019.09.12

[Signature]
 2
AM.Najuvudeen (MSI)
 Regd.Licd. Surveyor & Leveller
 Reg.No: 19921508

Annex: 02 Attendance Sheets of the participants during the meetings and discussions

1. Discussion about Social Safeguard & Gender maintain

THE WORLD BANK
 කෘෂිකර්ම, ග්‍රාමීය ආර්ථික කටයුතු, පළාත් සමාජ සංවර්ධන, වාරිකර්ම සහ ජීවර හා ජලජ සම්පත් සංවර්ධන අමාත්‍යාංශය
 கமத்தொழில், கிராமிய பொருளாதார அலுவல்கள், கால்நடை அபிவிருத்தி, நீர்ப்பாசனம், மீன்பிடி மற்றும் நீரியல்
 வளங்கள் அபிவிருத்தி அமைச்சு
 MINISTRY OF AGRICULTURE, RURAL ECONOMIC AFFAIRS, LIVESTOCK DEVELOPMENT, IRRIGATION AND
 FISHERIES AND AQUATIC RESOURCES DEVELOPMENT
 දේශගුණ සුදුසු වාරි කෘෂිකර්ම ව්‍යාපෘතිය / කාලநிலை சீரமைவு நீர்ப்பாசன விவசாயத் திட்டம்
 CLIMATE SMART IRRIGATED AGRICULTURE PROJECT
 PROJECT MANAGEMENT UNIT

District => Batticaloa
 Province => Eastern Province.

ATTNDANCE OF CBO MEETING

Asc. Division: *Vantharumalai* Place: *Vantharumalai ASL* Date: *17/12/2019*

Se.No	Name of the beneficiaries	Male/Female	Farmer Organization	WFO Farmer organization	Other CBOs	Signature
01.	<i>ක. ප්‍රසාද්</i>	M	<i>වත්තරුමාලි</i>			<i>K. Prasad</i>
02.	<i>ආ. ටිලක</i>	F	"			<i>S. Tilak</i>
03.	<i>ආ. ආනන්ද</i>	F	"			<i>A. Anand</i>
04.	<i>ක. කේ</i>	M	<i>වත්තරුමාලි</i>			<i>K. Ke</i>
05.	<i>ආ. ආනන්ද</i>	F	<i>වත්තරුමාලි</i>			<i>A. Anand</i>
06.	<i>ආ. ආනන්ද</i>	F	<i>වත්තරුමාලි</i>			<i>A. Anand</i>
07.	<i>ක. ආනන්ද</i>	F	"			<i>K. Anand</i>
08.	<i>ක. ආනන්ද</i>	M	"			<i>K. Anand</i>
09.	<i>වත්තරුමාලි</i>	M	Government	-	DS/EP, Kenkaki	<i>V. Tharumalai</i>
10.	<i>වත්තරුමාලි</i>	M	"	-	AJ/Vantharumalai	<i>V. Tharumalai</i>

Annex: 03 Public/ Community Consultation and Disclosure

Public / Community consultation conducted Location/ Venue	Consultation method	Date	Number of participants (Male, Female)	Details/Issues raised

Vantharumoolai ASC building	Focus Group discussion	13/11/2019	M - 04 F - 06	-
Vantharumoolai ASC building	Focus Group discussion, Social Safe Guard and Gender part	17/12/2019	M - 05 F - 05	-

Annex: 04 Pictures during the meetings, discussions and field visits

1. CBO Meeting - Social Safeguard & Gender part discussion





2. Agrarian Service Centre boundaries–trees identified in existing boundaries of the ASC



Right side Fence



Right side front fence



Right side middle fence

Right side fence

During field observation following trees identified in the proposed subproject activity of construction boundary wall. When go for construction of boundary wall that trees want to cutoff.

S. No	Name of tree existing	Number of trees
01	Neem tree	04
02	Eucalyptustree	01
03.	Palmyra tree	01
04.	Arecanut tree	02
05.	Acacia tree	01
06.	Manchavana tree	01
07.	Kalothiyai tree	01
Total		11

Annex: 05 Drawing of the subproject

Further Annexes 06

Table 01: Brief summary of the ASC Division

S. No	Name of the Division	No. of families	Female	Male	Total
1	Chenkalady-1	1124	1719	1523	3242
2	Chenkalady-2	561	1198	1089	2287
3	Kommathurai west	303	447	467	914
4	Kommathurai North	486	881	812	1693
5	Kommathurai East	536	1003	980	1983
6	Vantharumoolai East	995	1810	1709	3519
7	Vantharumoolai West	1132	2074	2039	4113
8	Mylaveduvan	73	124	129	253
9	Palacholai	504	903	802	1705
10	Mavadivempu-1	995	1694	1635	3329

11	Mavadivempu-2	726	1243	1294	2537
12	Sittandy-1	884	1590	1476	3066
13	Sittandy-2	283	467	473	940
14	Sittandy-3	659	1099	1055	2154
15	Sittandy-4	663	1113	1069	2182
16	Kaluvankerny-1	762	1373	1378	2751
17	Kaluvankerny-2	636	1140	1167	2307
18	Eralakulam	350	691	685	1376
19	Koduvamadu	430	760	630	1390
	Total	12,102	21,329	20,412	41,741

Source - Divisional Statistical Handbook, Eravurpattu DS Division, 2019

Table 02: Religion and Ethnicity of GN Divisions under the ASC Vantharumoolai

S.N	G.N Division	Religion (Total Number of families)					Ethnicity (Total Number of families)			
		Buddhist	Hindus	Islam	R.C	Other Christians	Sinhalese	Sri Lankan Tamil	Sri Lankan Moors	Burger
01	Chenkalady-1	...	1019	...	81	24	...	1124
02	Chenkalady-2	...	452	...	87	21	1	560
03	Kommathurai west	...	294	...	4	5	...	303
04	Kommathurai North	...	429	...	2	55	...	486
05	Kommathurai east	...	509	5	...	509
06	Vantharumoolai East	...	965	...	23	7	...	995
07	Vantharumoolai West	...	1097	35	...	1132
08	Mylaveduvan	...	72	1	...	73
09	Palacholai	...	483	...	4	16	1	502	...	1
10	Mavadivempu-1	...	879	116	...	995
11	Mavadivempu-2	...	698	28	...	726
12	Sittandy-1	...	880	4	...	884
13	Sittandy-2	...	281	2	...	283
14	Sittandy-3	...	659	659
15	Sittandy-4	...	660	...	2	663
16	Kaluvankerny-1	...	608	...	126	28	...	762
17	Kaluvankerny-2	...	526	...	55	55	...	636
18	Eralakulam	...	344	6	...	350
19	Koduvamadu	...	422	1	7	429	1	...

Source - Divisional Statistical Handbook, Eravurpattu DS Division, 2019

S.N	G.N Division	Income Level in Rs. (per month per family)				
		Below Rs.3,000.00	Rs.3,001.00 - 5,000.00	Rs.5,001.00 - 10,000.00	Rs.10,001.00 - 25,000.00	Above Rs.25,001.00
01	Chenkalady-1	4	42	131	476	471
02	Chenkalady-2	39	28	23	317	154
03	Kommathurai west	37	14	83	130	39
04	Kommathurai North	10	18	25	238	195
05	Kommathurai east	29	41	168	149	150
06	Vantharumoolai East	235	446	147	135	32
07	Vantharumoolai West	0	18	86	538	490
08	Mylaveduvan	8	21	22	22	0
09	Palacholai	58	27	85	196	138
10	Mavadivempu-1	178	136	120	478	40
11	Mavadivempu-2	122	256	233	60	55
12	Sittandy-1	67	64	173	519	61
13	Sittandy-2	50	34	120	36	43
14	Sittandy-3	13	61	205	145	235
15	Sittandy-4	59	63	167	310	64

Table 03: Income level in GN Division – Vantharumoolai ASC Division

16	Kaluvankerny-1	135	154	275	121	140
17	Kaluvankerny-2	61	67	148	279	81
S.No	GN Division	Skilled Labours		Un-Skilled Labours		26
		Male	Female	Male	Female	24
01	Chenkalady-1	36	249	1680	96	2531.....
02	Chenkalady-2	26	26	29	4238.....
03	Kommathurai west	42	8	
04	Kommathurai North	9	49	26	
05	Kommathurai east	37	9	13	
06	Vanthurumoolai East	32	113	15	
07	Vanthurumoolai West	18	60	20	
08	Mylaveduvan	4	6	
09	Palacholai	5	21	15	
10	Mavadivempu-1	15	7	63	
11	Mavadivempu-2	17	45	20	
12	Sittandy-1	20	71	35	
13	Sittandy-2	8	41	2	
14	Sittandy-3	20	63	19	
15	Sittandy-4	47	5	
16	Kaluvankerny-1	20	140	48	

Sou
rce
-
Divi
sion
al
Secr
etari
at,
Era
vur
patt
u,

Village Development Plan - 2019

17	Kaluvankerny-2	30	11	88	49
18	Eralakulam	20	24	5
19	Koduvamadu	11	16

**Table
04:
Skilled and Unskilled labours in Vantharumoolai ASC, Batticaloa.**

led and Unskilled labours in Vantharumoolai ASC, Batticaloa.

Source - Divisional Secretariat, Eravurpattu, Village Development Plan - 2019

Table 05: Officers Details - ASC Vantharumoolai, Batticaloa District.

S.No	Name of Staff	Designation	Male/Female
01	Mr.I.Badurdeen	ADO	Male
02	Mrs.T.Sivaprahasam	ASC.MA	Female
03	Miss.T.Sugunalojini	ASC.MA	Female
04	Mrs.N.Kajendran	DO	Female
05	Mrs.S.Rajkumar	DO	Female
06	Mrs.P.Thiyagarajah	DO	Female
07	Mr.P.Rishitharan	DO	Male
08	Mrs.T.Vijitha	DO	Female
09	Mrs.Y.Vikraman	DO	Female
10	Mrs.S.Sivanantharajah	DO	Female
11	Mrs.K.Selvanayaki	DO	Female
12	Mr.C.M.Abdul Rahman	DO	Male
13	Mr.M.Rajeevthanan	A.R.P.A	Male

14	Mr.M.K.Mohamed Nowfer	Labour	Male
15	Mr.G.Sathananthan	Labour	Male
16	Miss.S.Tharishika	Temporary Staff	Female

Source: ASC - Vantharumoolai

Table 06: Farmers visit to ASC Vantharumoolai (Approximately)

One Day	Male Farmers	Female Farmers
In Season Time	104	56
Off Season Time	26	12

S.No	Name of the Farmer Organizations	Executive Committee members		Total Members
		Male	Female	
01	Puthuvelikulathuvaddai	7	4	11
02	Pallaththuveli	8	2	10
03	Periyavaddavanvadakku	8	5	13
04	Puloodumanodai	11	4	15
05	Kurukanamadu	8	3	11
06	Kulaththuvaddai	9	1	10
07	Palamadu vadakku	8	2	10
08	Aliya oodai	7	3	10
09	Periyathurai	6	4	10
10	Samulanguda	8	1	9
11	Vitpanaimadu	8	2	10
12	Samulaiyadippothonai	7	4	11
13	Mayilavaddan	5	5	10
14	Eralakkulam	8	1	9
15	Sinnaththuarichchenai	8	3	11
16	Sonakanvaddai	7	4	11
17	Periyavaddavan thetku	5	5	10

Source:
ASC -
Vantharu
moolai

**Table 07:
Details of
Farmer
Organizations and
Executive
committee
members
in ASC
Vantharu
moolai**

18	Ingiriyamadu	5	5	10
19	Kayanadi	5	5	10
20	Peruveli	5	5	10
S.No	GN Division	Women Farmer Organization	3	Total Number of Members
21	Navundandi	5	5	10
22	Illukkupoththanai	5	5	10
013	Periyayaddan Kilaku	7	4	11
024	Kaluvankerny-1	12	1	13
03	Sinnaaveli sinnalanveli	12	1	13
03	Mylaveduvan	Maha		25
04		Laxmi		25
05	Vantharumoolai West	Kaveri		25

Source: ASC - Vantharumoolai

Table 08: Details of Women Farmer Organizations in ASC Vantharumoolai

06		Mallikai	25
07		Sivasankari	25
08	Vantharumoolai east	Vennila	25
09		Vasantha	25
10		Sahana	25
11	Kommathurai west	Thamarai	25
12		Tharakai	25
13		Nadohatira	25
14	Kommathurai east	Kanthi	25
15	Kommathurai North	Kalaivani	25
16	Mavadivempu-1	Ilamtalir	22
17		Kannaki	25
18	Eralakulam	Annai	25
19	Mavadivempu-2	Thurka	25
20	Palacholai	Theechudar	25
21	Chenkalady-1	Anthooriyam	25
22	Chenkalady-1	Cevvanthi	25
23	Sittandy-3	Jamunai	25
24		Srimurugan	25
25	Sittandy-4	Puspam	25
26		Ulutunduvalvar	25
27	Sittandy-1	Poovanam	25
28	Mavadivempu-1	Kannaki	25
29	Periyavedduvan	Senthamarai	25
30	Palacholai	Naachiyar	25

Source:
AS
C -
Van
thar
um
oola
i

Tab
le
09:
Na
me
of
Vill
age

s by GN Division

S.No.	Name of G. N. Division	G.N. Number	Number of Villages	Name of Villages
1	Chenkalady - 1	195/1	4	PillaiyaradyVaddaram, Kanapathipillai Puthiyannagar, Ramespuram, ChenkaladyVaddaram
2	Chenkalady - 2	195	5	Andarkulam, SanthiveethiVaddaram, Puthucolany, Badulla road Vaddaram, Chenkalady-Part
3	Kommathurai-West	196A	3	Kommathurai-West, Puranvalavu, Kommathuraitheevu
4	Kommathurai -North	196B	3	Kommathurai-North, KommathuraiColany, Orumulachchulai
5	Kommathurai - East	196	1	Kommathurai-East
6	Vantharumoolai - East	197	2	Vantharumoolai-East, Devapuram
7	Vantharumoolai - West	197B	1	Vantharumoolai-West

8	Mylavedduvan	197D	3	Mylavedduvan, Veerakkadduru, Mangalamadu
9	Palachcholai	197C	4	Pesinkiramam, Lake House Thoddam, Palacholai Center, Elichchi Kiramam
10	Mavedivembu - 1	197A	3	New Colanization, PalayaMavadivembu, VambarkarColony
11	Mavedivembu - 2	197E	1	Mavedivembu Part
12	Sittandy - 1	201/1	2	Sittandy Part, VinayagarKiramam,
13	Sittandy - 2	201/2	1	Sittandy
14	Sittandy - 3	201/3	8	Kudavaddai, Perumavelly, Vellayanchenai, Puthuvelikulam, Thuraiyadiveddi, Sittandy Part, Panankadu
15	Sittandy - 4	201	3	Sittandy Part, Mathurankaddu Kolony, Uthyanmoolai
16	Kaluvankerny - 1	198	8	Palayadithona, PakkiyapuraColony, Nediyaadu, Koralankerny, Kaluvankerny- (Akkarai), Model Village North, Mavadipattu, Suruppukerny
17	Kaluvankerny - 2	198A	6	Sappaikerny, Sambukerny, Kaluvankerny, Senaikkandam, Singarathoppu, Cey-Nor Housing Project
18	Eralakkulam	201A	39	Aliyaodai, Kuruganamadu, Samulancholaikulam, Visarai, Kansanveddai, Kayanady, Peryaveddavan South, Sinnathuraichenai, Kudaveddai, Vellaiyanadachenai, Varadichchasalai, Periyavaddavan North, Mullivadavan, Kadasimalai, Thavanaivaddai, Samulaiyadipothanai, Eralakkulam, Vadinugaravelly, Enkiriyaadu, Suladiyaadu, Ahathiyarkulam, Avaddiyavelly, Verupputhavelly, Ayamanai, Ammanady, Akkaraththavanai, Navundaniyaadu, Vitpanamaui, Puluddumanodai, Kilavankanduchenai, Karukkuveddai, Veddinavaikal, Polisirakuda, Ellukku, Vilanthoddam, Alagarveddai, Munthankumaravelly, Vathiraveddai, Ethasirakandam, Veram
19	Koduvamaadu	195A	3	Koduvamaadu, Kayankuda, Thampanamvelly
Total villages				

Source - Divisional Secretariat, Eravurpattu, Village Development Plan - 2019

Table 10: Religious places in Vantharumoolai ASC Division

S.No	Name of the GN Division	Religious place					
		Buddhist	Hindu	Roman Catholic	Other Christian	Islam	Total
1	Chenkalady-1	0	4	0	1	0	5
2	Chenkalady-2	0	3	0	0	0	3
3	Kommathurai west	0	5	0	0	0	5
4	Kommathurai North	0	3	0	1	0	4
5	Kommathurai East	0	1	1	0	0	2
6	Vanthurumoolai East	0	7	1	1	0	9
7	Vanthurumoolai West	0	5	0	1	0	6
8	Mylaveduvan	0	1	0	0	0	1
9	Palacholai	0	7	0	1	0	8
10	Mavadivempu-1	0	6	0	2	0	0
11	Mavadivempu-2	0	1	1	0	0	2
12	Sittandy-1	0	2	0	0	0	2
13	Sittandy-2	0	2	0	0	0	2
14	Sittandy-3	0	3	0	0	0	3
15	Sittandy-4	0	4	0	0	0	4
16	Kaluvankerny-1	0	4	2	1	0	7
17	Kaluvankerny-2	0	7	1	2	0	10
18	Eralakulam	0	1	1	0	0	2
19	Koduvamadu	0	6	0	0	1	7
	Total	0	72	7	10	1	82

Source - Divisional Secretariat, Eravurpattu, Village Development Plan - 2019

Table 11: Number of Samurdhi Beneficiary families

S. No	GN. Division	Total
1	Chenkalady-1	294
2	Chenkalady-2	309
3	Kommathurai west	164
4	Kommathurai North	252
5	Kommathurai East	236
6	Vanthurumoolai East	485
7	Vanthurumoolai West	412
8	Mylaveduvan	22
9	Palacholai	189
10	Mavadivempu-1	439
11	Mavadivempu-2	288
12	Sittandy-1	341
13	Sittandy-2	144
14	Sittandy-3	354
15	Sittandy-4	254

16	Kaluvankerny-1	594
17	Kaluvankerny-2	419
18	Eralakulam	155
19	Koduvamadu	340
	Total	5,691

Source - Divisional Secretariat, Eravurpattu, Village Development Plan - 2019

Table 12: Family head Details in Vantharumoolai ASC Division

S.No	Name of the Division	Women Headed families	Widow Headed families	Disable Headed families	Child Headed families	Elder Headed (over 65) families
1	Chenkalady-1	16	84	3	0	24
2	Chenkalady-2	14	28	4	0	27
3	Kommathurai west	13	54	0	0	21
4	Kommathurai North	57	63	3	1	72
5	Kommathurai East	45	75	6	0	36
6	Vantharumoolai East	39	163	15	0	113
7	Vantharumoolai West	32	177	11	2	95
8	Mylaveduvan	0	14	1	0	9
9	Palacholai	8	38	4	0	51
10	Mavadivempu-1	162	128	6	0	82
11	Mavadivempu-2	21	76	4	0	80
12	Sittandy-1	6	40	1	0	0
13	Sittandy-2	64	47	4	0	21
14	Sittandy-3	19	112	22	0	114
15	Sittandy-4	17	56	11	5	62
16	Kaluvankerny-1	15	137	28	0	0
17	Kaluvankerny-2	17	87	5	0	37
18	Eralakulam	14	56	2	0	72
19	Koduvamadu	25	46	1	0	53
20	Pankudavely	4	77	2	0	11
	Total	588	1,558	133	8	980

Source - Divisional Secretariat, Eravurpattu, Village Development Plan - 2019
